



THROUGH WALL FAN KITS - Standard

These efficient fan kits are easy to install and are designed to be ducted straight through an exterior wall. All fan kits include a weatherproof cowl. Models featuring a low profile fascia offer a more stylish and unobtrusive installation into any wall and are supplied with an exterior grille. Other models are supplied with an exterior cowl. 5 year warranty.

Pro-Series Low Profile	Duct (mm)	Fan Type	Max. Fan Watts (W)	Max. Fan Pressure (Pa)	Free Air Fan Performance		Specific Fan Power (W/l/s)	Sound dB(A)	Fascia	Switching	Model	Order Code
					(l/s)	(m ³ /hr)						
	150	Axial	20	60	101	364	0.19	40	Square	Standard	XPLP150SS	FAN0621
										Timer	XPLP150ST	FAN0623
	125	Axial	20	35	36	130	0.56	41	Square	Standard	XPLP125SS	FAN0614
										Timer	XPLP125ST	FAN0615
Classic Standard Profile	Duct (mm)	Fan Type	Max. Fan Watts (W)	Max. Fan Pressure (Pa)	Free Air Fan Performance		Specific Fan Power (W/l/s)	Sound dB(A)	Fascia	Switching	Model	Order Code
					(l/s)	(m ³ /hr)						
	300	Axial	82	60	306	1100	0.27	60	Square	Standard	XPS300S	FAN2042
	230	Axial	45	50	152	550	0.30	50	Square	Standard	XPS230S	FAN0455
	150	Axial	20	60	101	364	0.19	40	Square	Standard	XP150S	FAN0135
										Pull Cord	XP150P	FAN0140
	125	Axial	20	35	36	130	0.56	41	Square	Timer	XP150T	FAN0141
										Standard	XP125S	FAN0080
	100	Axial	20	20	23	85	0.87	41	Square	Pull Cord	XP125P	FAN0082
										Timer	XP125T	FAN0083
	100	Axial	20	20	23	85	0.87	41	Square	Standard	XP100S	FAN0053
										Pull Cord	XP100P	FAN0054
100	Axial	20	20	23	85	0.87	41	Square	Timer	XP100T	FAN0055	

Note: Installed system performance is always influenced by duct length and layout

Switching Options

Standard Remote switch (not supplied).

Timer Remote switch (not supplied). Fan continues operating for preset time after switching off. 150mm models include fixed 7 minute timer. 125mm and 100mm model timers are 1-20 minute adjustable and require permanent and switched phase.

Pull Cord Integral part of fan.

Accessories

Fascia	Model	Duct	Round			Square		
			White	Satin Silver	Chrome	White	Satin Silver	Chrome
	XPLP	150mm	FAN0750	FAN2070	FAN0613	FAN0749	FAN2071	FAN0598
		125mm	FAN0748	FAN2069	FAN0757	FAN0747	FAN2068	FAN0755

THROUGH WALL FAN KITS - Standard

Dimensions (mm)

Model	Cut-Out Size	A	B	C	D	E	F	G	H
XPLP150	173	174	30	150	375	148	132	10	191
XPLP125	140	160	30	125	375	123	128	10	161
XPS300	310	350	50	230	375	298	156	81	362
XPS230	265	286	30	250	375	248	141	75	586
XP150	160	174	30	150	375	148	74	27	200
XP125	140	160	30	125	375	123	74	27	168
XP100	112	138	30	100	375	98	74	27	155

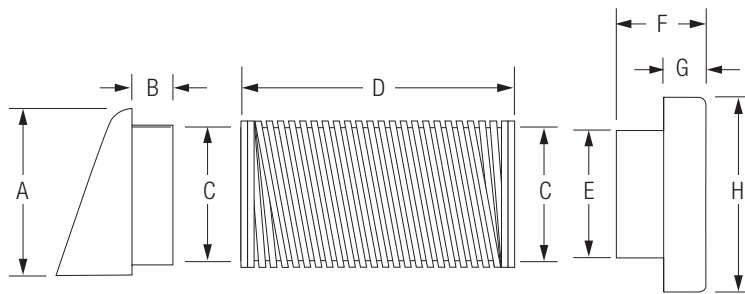

XPLP / XP

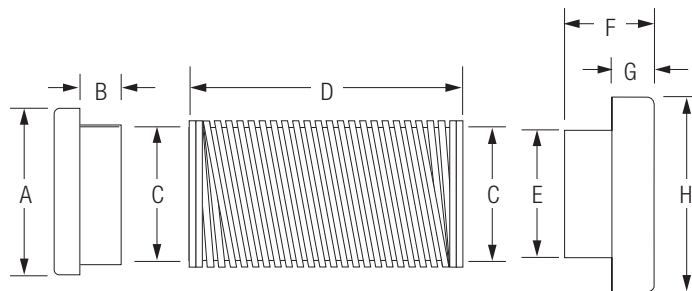

XPS

Technical

Model	XPLP	XPS	XP
Supply	220-240V AC, 50Hz		
Max. Operating Temp	50°C	50°C	50°C
IP Rating	IPX4	IPX4	IPX4
Exterior Grille	Weatherproof Cowl	White Fixed Grille	Weatherproof Cowl
Duct	Aluminium Semi-Rigid	Aluminium Semi-Rigid	Aluminium Semi-Rigid
Duct Length	375mm	375mm	375mm