

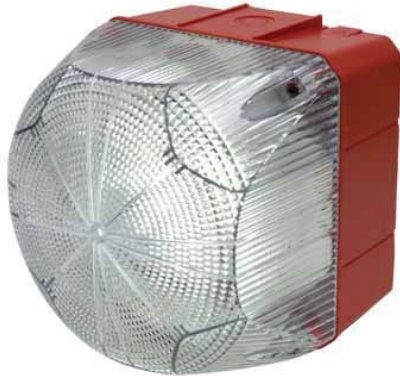

# LED STEADY & FLASHING BEACONS ALL IN ONE UNIT



**QDM  
120 Cd**



**QDS  
10 Cd**

- Comprehensive range of cubic design beacons in LED
- Electrical connection via cage clamp
- Unique beacon/lens design
- Versatile installation and mounting options
- Fit for plc applications (leakage, inrush current)
- Life 50,000 hrs approximately
- Flexible combinations of Beacons and Sounders possible with accessory kits
- Colour combinations for industrial or general applications can be realized

lateral cable entry on both sides for cable gland

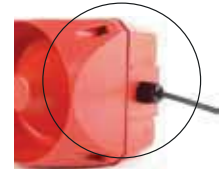

grommet for rear cable entry



**QDS**

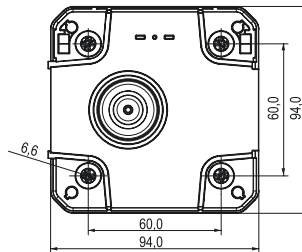

**QDM**

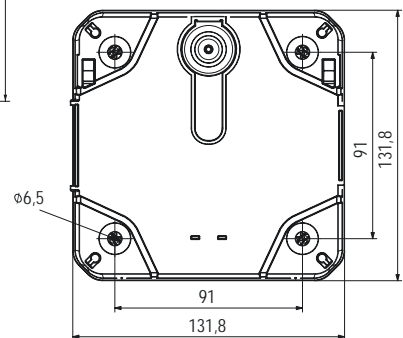

**Part Numbers:**

**QDM VOLTAGES 110V-240VAC/DC**

- QDM-240V-AMBER
- QDM-240V-GREEN
- QDM-240V-RED
- QDM-240V-CLEAR
- QDM-240V-BLUE

**QDS VOLTAGES 240VAC**

- QDS-240V-AMBER
- QDS-240V-GREEN
- QDS-240V-RED
- QDS-240V-CLEAR
- QDS-240V-BLUE

**QDM VOLTAGES 24-48VAC/DC**

- QDM-24V-AMBER
- QDM-24V-GREEN
- QDM-24V-RED
- QDM-24V-CLEAR
- QDM-24V-BLUE

**QDS VOLTAGES 24VAC/DC**

- QDS-24V-AMBER
- QDS-24V-GREEN
- QDS-24V-RED
- QDS-24V-CLEAR
- QDS-24V-BLUE



# Possible Combinations & Accessories

## Products Sold Separately

QDS Beacon + ASS -T Sounder



QDS or QDM Beacons +  
ESG or ESM or BIP92 Buzzers



QDM Beacon + ASM Sounder



3 x QDM or QDS Beacons

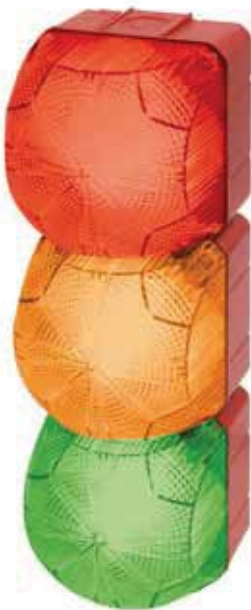

2 x QDM Beacons + ASM Sounder or  
2 x QDS Beacons + ASS - T Sounder



**Part Numbers:**

Bracket - AB1 for mounting QDS and ASS - T  
Bracket - AB2 for mounting QDM and ASM  
for mounting of sounders or beacons



**Part Number:**

Coupling - Kitamk  
for mounting/combination of 2 or more  
same size sounders or beacons



**Part Numbers:**

Gasket - AG1 for mounting QDS and ASS - T  
Gasket - AG2 for mounting QDM and ASM  
for correct IP66 installation on smooth surfaces

